

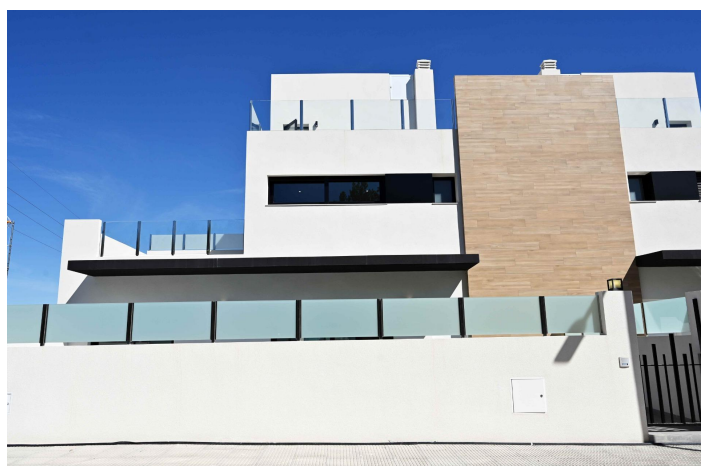

## Townhouse for sale in Orihuela Costa, Orihuela

**358,000 €**

Reference: N6851   Bedrooms: 2   Bathrooms: 2   Plot Size: 178m<sup>2</sup>   Build Size: 97m<sup>2</sup>   Terrace: 73m<sup>2</sup>

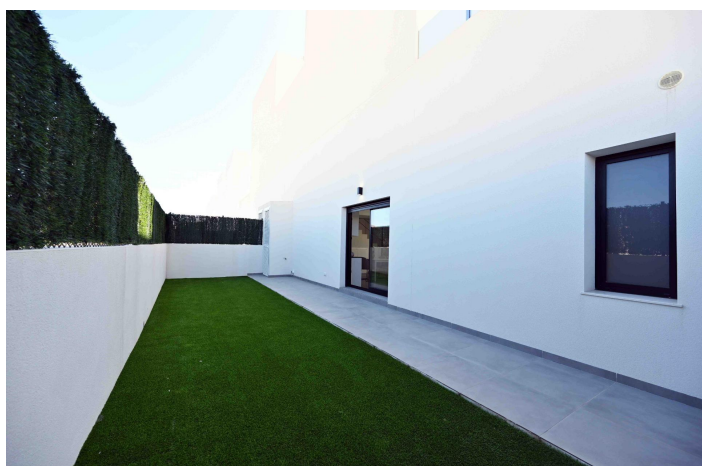
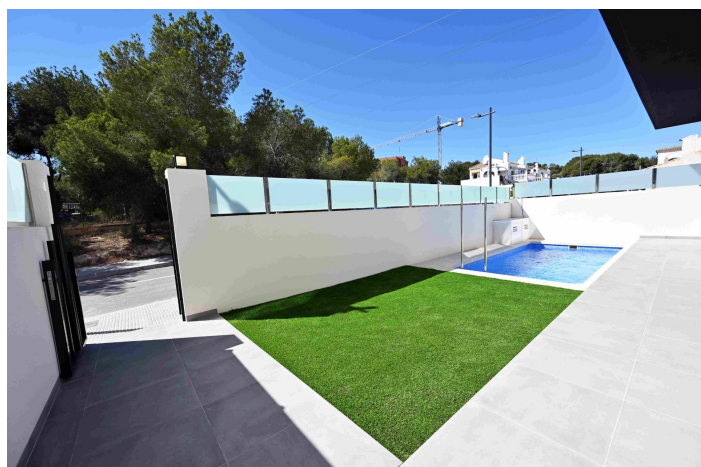



---

## Costa Blanca South, Orihuela Costa

### NEW BUILD TOWNHOUSES IN ORIHUELA COSTA

New Build townhouses in Las Filipinas, Orihuela Costa.

The complex of 12 townhouses, each with 2 bedrooms, 2 bathrooms, front and back yards and their own roof terrace.

On the ground floor there is a bright living room with an open-plan kitchen, a spacious bedroom with built-in wardrobe and a bathroom.

On the first floor there is a second large bedroom with built-in wardrobe and a bathroom. From the bedroom there is an exit to a sunny balcony with space for terrace furniture.

Upstairs you have the roof terrace where you can place an outdoor kitchen, jacuzzi and chill-out area.

The properties come with pre-installed ducted A/C, fitted bathrooms, aerothermic hot water system, intercom, LED lighting package, outdoor kitchen and parking space.

Private swimming pool 5.5 x 2.5 m .

Development located near three popular golf courses (Villamartin, Las Ramblas and Campoamor), just five minutes from the best beaches of Orihuela Costa.

Within a few minutes' walk you will find all services such as bars, restaurants and shops, La Fuente shopping center.

Las Filipinas located around 10 minute's from the famous Villamartin Plaza & Golf Course where you will find numerous bars & restaurants, supermarket, banks, a taxi rank & the local bus stop.

The golden Orihuela Costa beaches are just 5 minutes drive away as is the new Zenia Boulevard shopping Mall (largest shopping mall in Alicante province with the biggest Primark clothing store in Europe).

There are 3 other golf courses all within 5 minutes drive. There are tennis courts & tennis coaching available at the nearby Campoamor hotel. Alicante & Murcia airports are 45 minutes drive away.



## Features:

### Features

Garden  
Solarium: Yes  
Near Commercial Center  
Useable Build Space: 80 Msq.  
Double Bedrooms: 2  
Beach: 5000 Meters  
Location: Coastal, Urbanisation  
Private Pool  
Parking - Space  
Air Conditioning: Pre-Installed  
Gated  
Number of Parking Spaces: 1  
Near Schools  
Terrace: 73 Msq.

### Energy Rating

B

### CO2 Emission Rating

B